



Quick Install Guide

CellGate Support: 972-231-1999 option 2

Recommended wiring: 18/6 shielded for main device, and 18/4 shielded for optional wiegand devices ⚠️

Items Included in Kit

- | | |
|---|-------------------------------|
| 1 Watchman EVO Unit | 6 Bolts X 4 |
| 2 12 Volt DC Power Supply | 7 Quick Install Guide |
| 3 Magnetic Read Switch ⚠️ | 8 Activation & Test Process |
| 4 Keys <i>(Note: Leave one key with the customer)</i> | 9 Customer Information Packet |
| 5 Nuts X 4 | |

Watchman EVO Unit

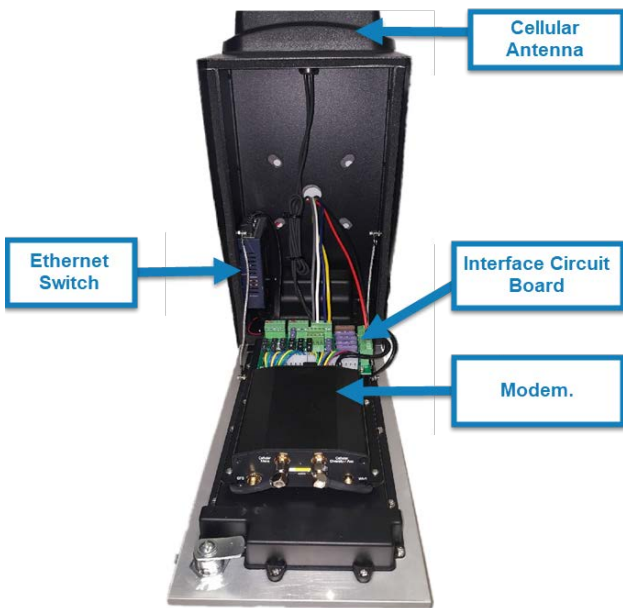

Power Supply Wiring

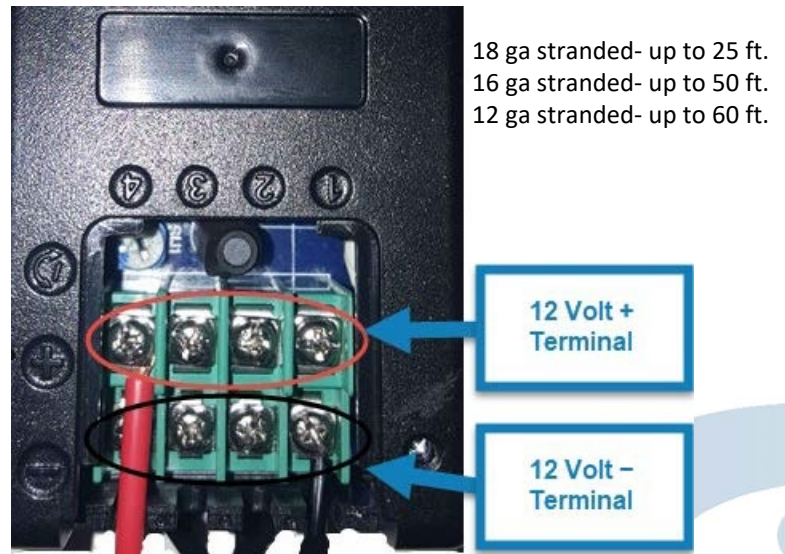

Interface Circuit Board (Oriented the same as the Watchman install)

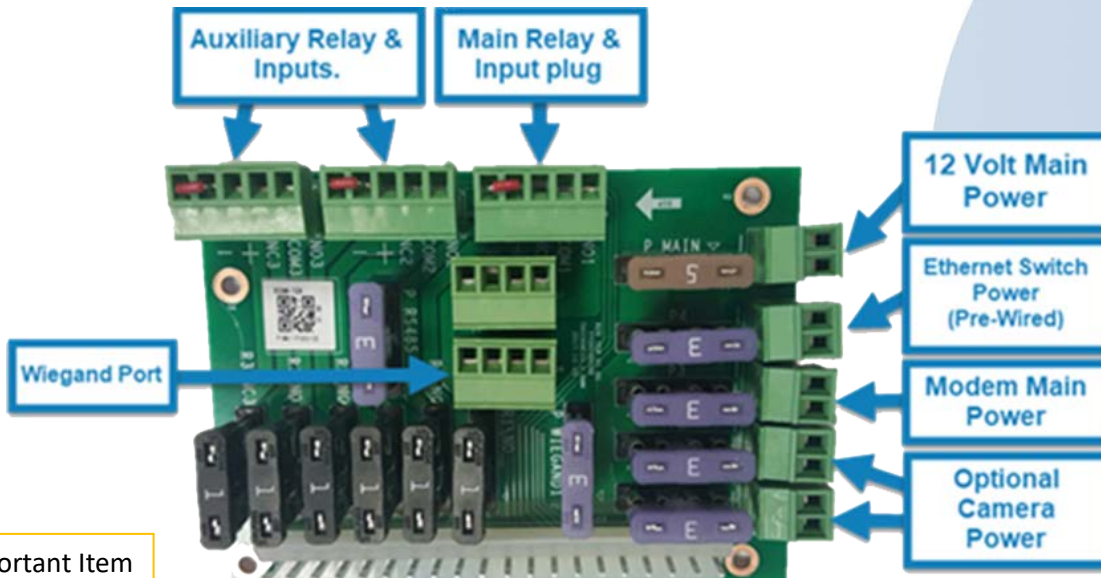

⚠️ Important Item

Internet Router connection

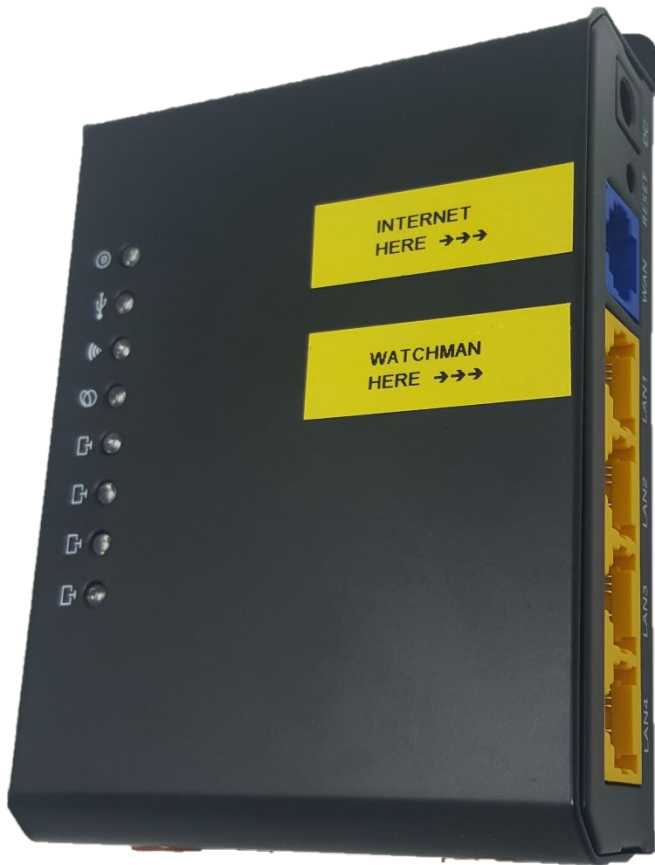

Plug Customer
Internet into the blue
Port!

Plug Watchman into
any Yellow Port!

Plug Optional
External Cameras
into any Yellow Port!

Interface Wiring Diagram (Oriented the same as the Watchman install)

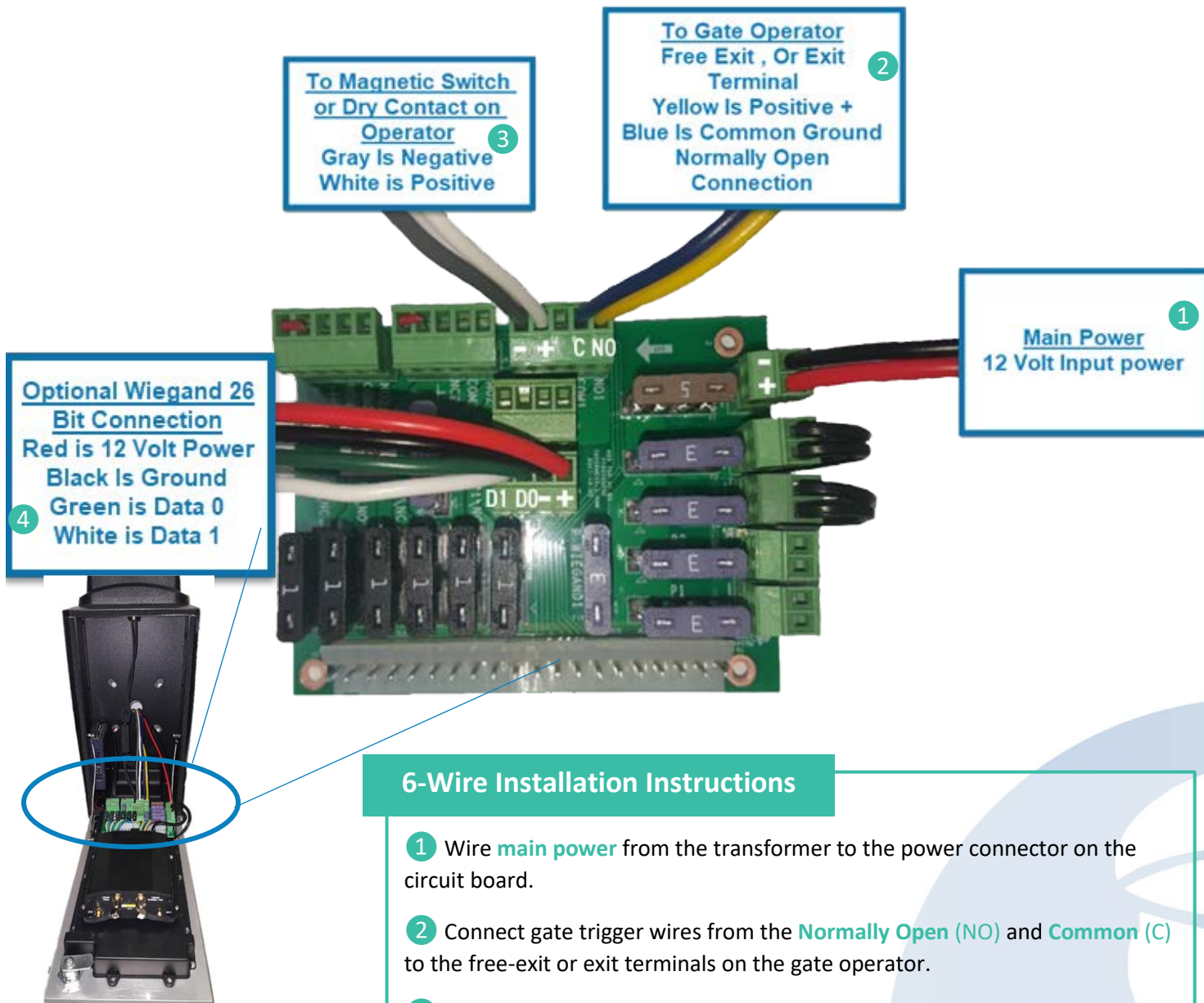

6-Wire Installation Instructions

- 1 Wire **main power** from the transformer to the power connector on the circuit board.
- 2 Connect gate trigger wires from the **Normally Open (NO)** and **Common (C)** to the free-exit or exit terminals on the gate operator.
- 3 Connect the gate status wires on the 6 pin connector on the main relay and input plug to the magnetic switch or a **Dry Contact**, Normally Closed (NC) relay on the gate operator.
- 4 If using an optional 26-bit reader (ex., keypad, card reader, RFID, or clicker), wire the device to the **Wiegand connection** on the interface circuit board.
- 5 Use **Camera Guide** if adding optional external camera.
- 6 Test/activate using the test credentials on the **Activation & Test Process** document. ⚠

⚠ Important Item