

1812 CCTV CAMERA KIT

DoorKing Part Number

1812-147

The camera in this kit is a high quality camera with 520 lines of resolution. Minimum illumination is required (.25 Lux). The camera automatically switches from color to black and white in low light conditions. **Not** for use in 1812 Wall Mount Models.

See 90 Series manual to install camera into 1835/1837.

Kit Includes: Camera on mounting bracket, Camera harness, CCTV Circuit board, 2 plastic collars and screws, 12 VDC transformer, Plastic lens.

Installation

Disconnect power to 1812 !!

Remove 1812 circuit board (Not shown):

CAUTION The 1812 circuit board contains static sensitive components. Discharge any static electricity from your hands by touching a proper ground device **before** removing the circuit board.

1. Disconnect front door accessories plug, 18-pin main terminal connector and keypad plug from 1812 circuit board.
2. Remove 4 corner screws from the circuit board. Remove circuit board.
3. Run the CCTV camera RG-59U Coax and power wires to the 1812 through the existing conduit.

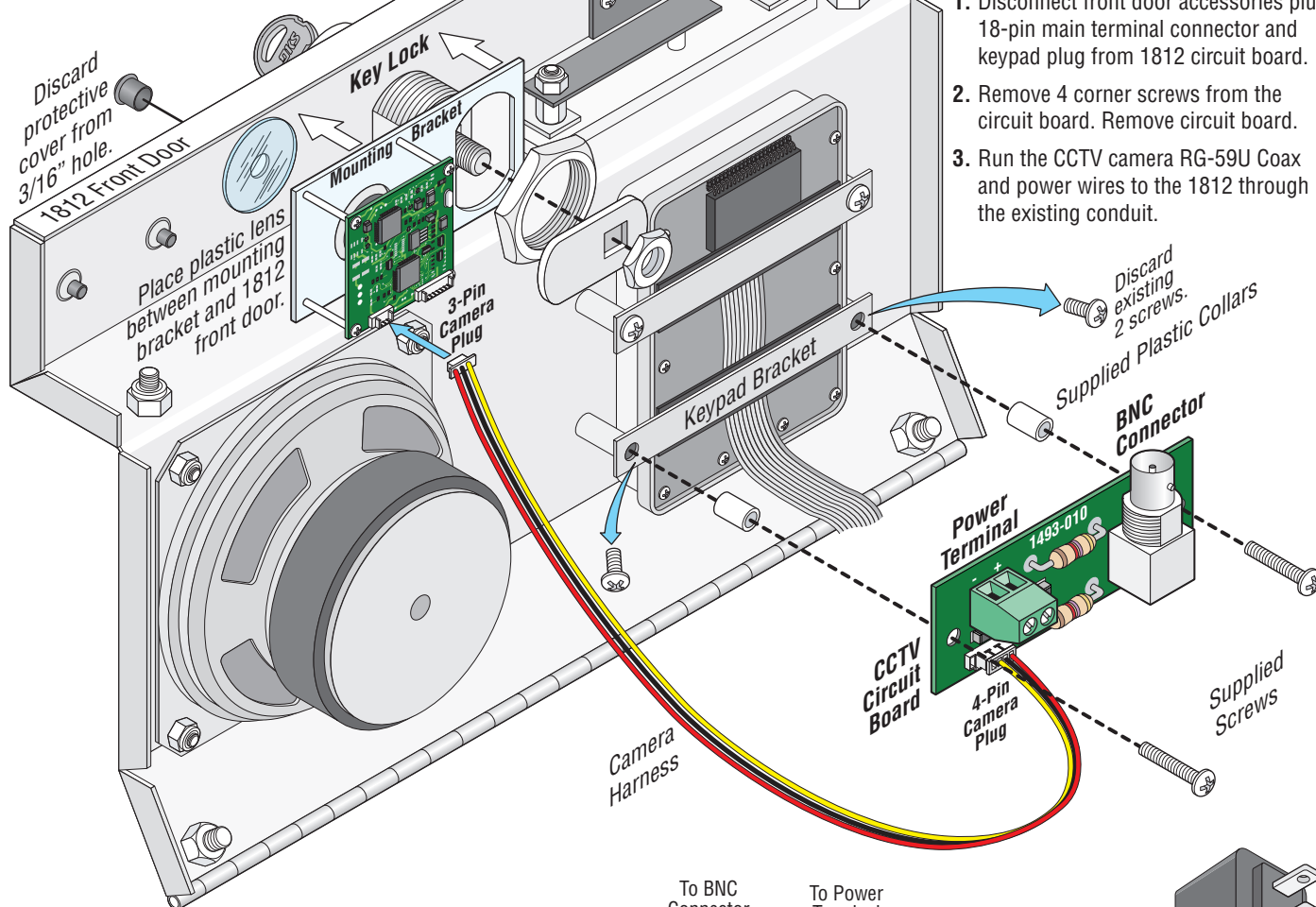

CCTV Circuit Board Connections

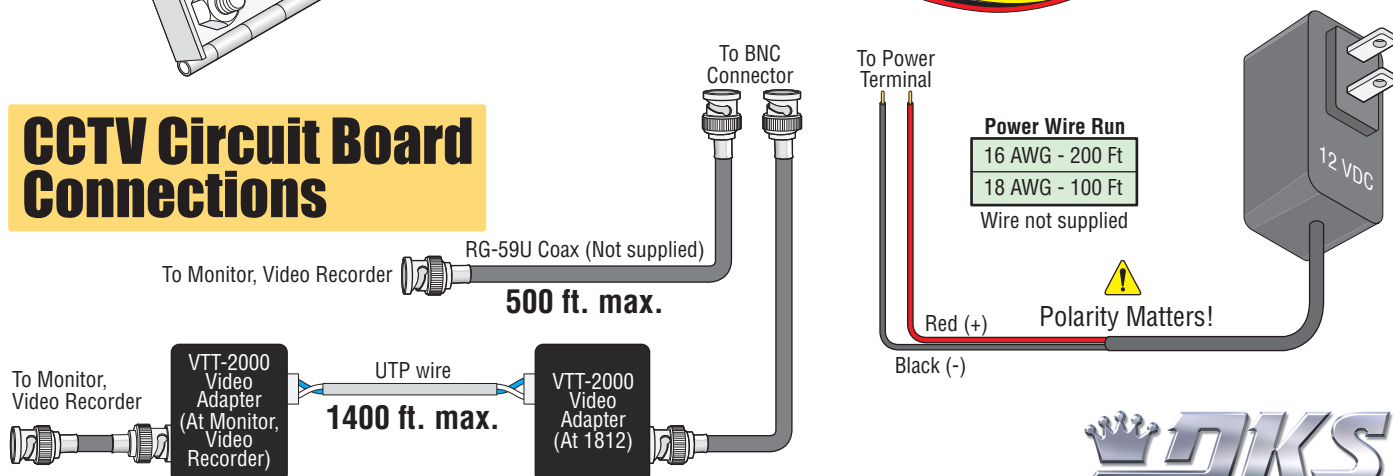

DoorKing offers video adapters (Not supplied) for up to 1400 ft using unshielded twisted pair telephone wire. (P/N 1812-039)