

Smart Touch Display Board

A slot in the middle of the display board allows free passage of the keypad's ribbon cable and makes for an easier installation. It eliminates the necessity to bend the ribbon cable around two tight corners and reduces wear and chaffing against the lid of the Control Box.

Installing the Display Board

To install a new Display Board, take the following steps:

1. Turn OFF power to the Control Box.
2. Disconnect the two ribbon cables attached to the Display Board.
3. Using a Phillips-head screwdriver, remove the four screws that secure the Display Board to the lid of the Control Box. Let the ribbon cables hang as you remove the Display Board and set the four screws aside.
4. Align the holes in the replacement Display Board with the mounting standoffs and thread the blue/green keypad cable through the slot. Note the orientation of the Display Board. Refer to the photo on page 2.

NOTE: Make sure there are no twists in the ribbon cables. Do not force the ribbon cable's connection. The connectors are keyed so if it is difficult to connect, reassess the alignment as it will only go in one way.

5. Reattach the Smart Touch Control (STC) board's ribbon cable to the Display Board.
6. Align the holes in the Display Board with the mounting standoffs and reinsert the four Phillips-head screws. Tighten the screws to secure the board.
7. Close the Control Box lid.
8. Turn ON power to the Control Box and run a test cycle of the gate to make sure the operator and the display are working properly.

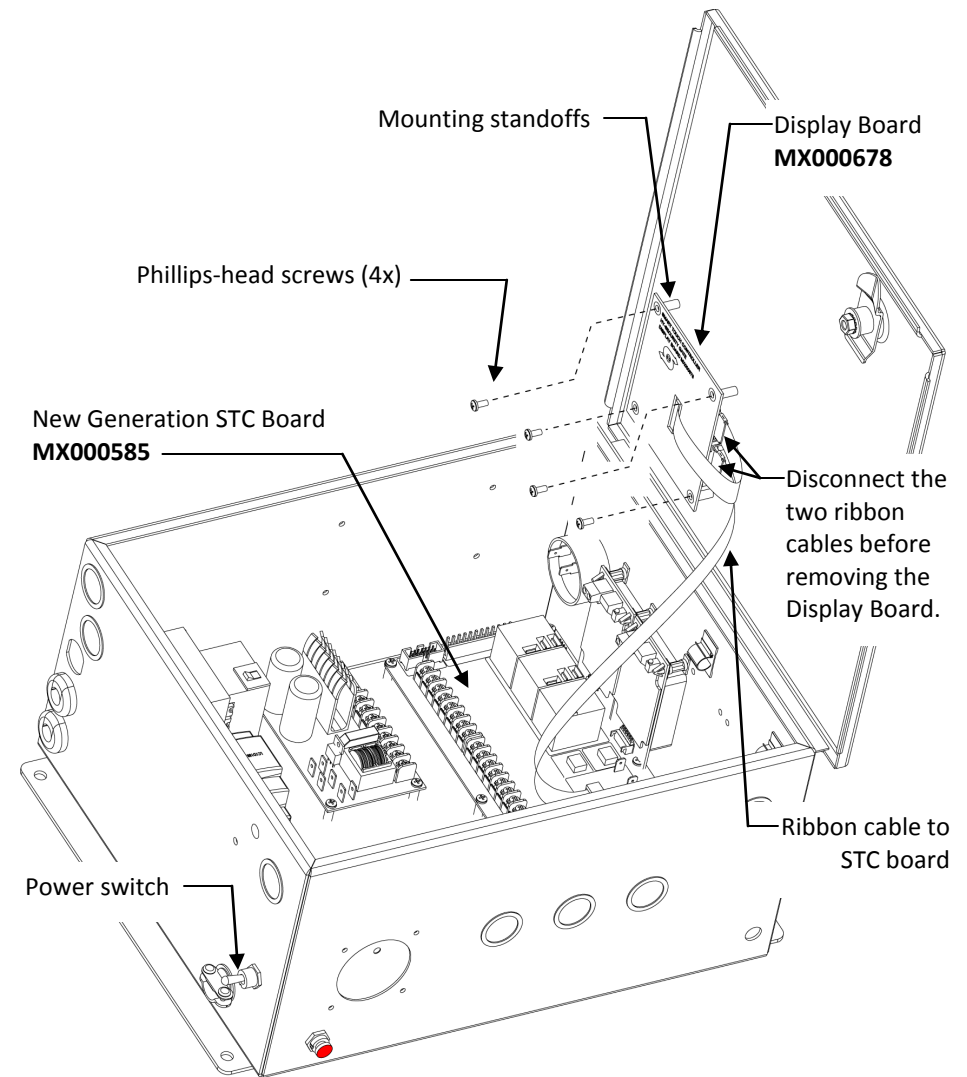

Control Box—Display Board assembly

Compatibility Issues

If you are replacing an STC board in a Master/Slave situation, both STC boards must be the same type. If you are replacing a Classic STC board with a New Generation STC board, you must be sure the Display Board's part number is MX000678. Otherwise, ground loop issues may occur. A Technical Bulletin (D0327) explains several scenarios when replacing a Classic STC board with a new Generation STC board. The Technical Bulletin (D0327) is available on the HySecurity website.

Technical Support

For Technical support, call your authorized HySecurity distributor. Obtain the serial number of your operator before calling. For the name of the distributor near you, call HySecurity at 800-321-9947.

For information about HySecurity training for installers, maintenance personnel and end users, refer to the company website at www.hysecurity.com or call 800-321-9947.

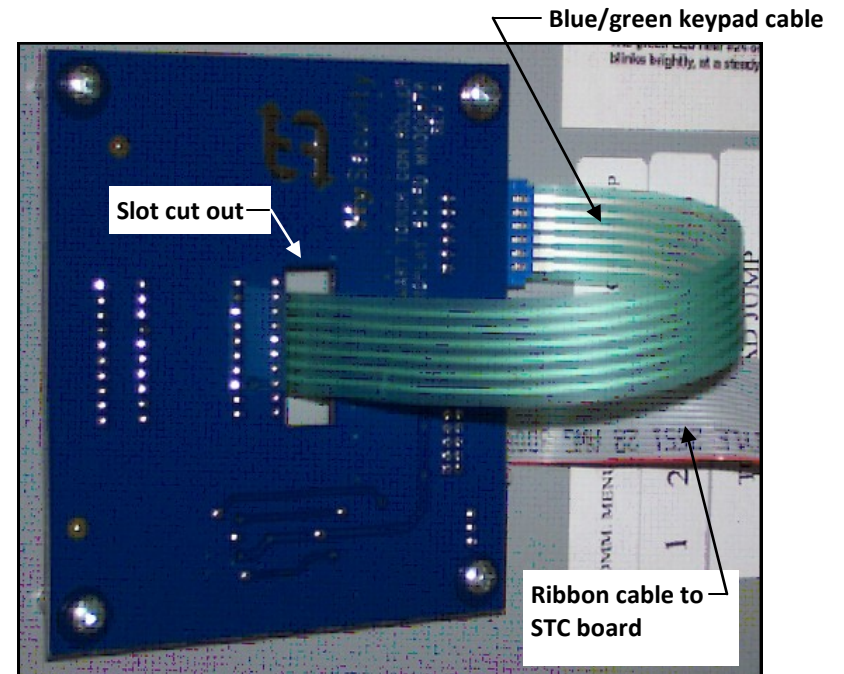

Display Board with new slot cut out