

## Install Kit (order separately)

MX002750: Transfer punch, Drill jig, Countersink drill bit

## Tools required

Hacksaw	Hammer
Cordless drill	Channel locks
¼-inch drill bit	Permanent marker
Phillips-head screwdriver	Blue Loctite

## Site Planning & Installation Tips

- At retrofit sites, the rack can be installed on the flanged drive rail or the standard grooved drive rail.
- The rack is 0.4-inches (1.0cm) thick and mounts beneath the drive rail. You will need to raise the drive rail ¼ to ½ inch (3 to 13mm) along the gate uprights and the entire drive rail path, especially if the operator has 8-inch (20cm) wheels.
- Replace the bottom drive wheel with the XtremeDrive™ drive wheel. The XtremeDrive drive wheel is not used along the top surface of drive rail.
- Limit switches - check their position and make the necessary adjustments to accommodate for the rack and XtremeDrive drive wheels.



Turn OFF power to the gate operator and take the necessary precautions to avoid electrical shock.

## XtremeDrive™ System

### 1 Remove the SlideDriver cover and turn OFF power.

**NOTE:** *Unlock the cover, if necessary.*

1. Loosen the two Phillips-head screws at the base of the cover.
2. Lift the cover off the operator and set it aside.
3. Turn OFF power using the power switch on the control box.



Mount the rack onto one section of the drive rail at a time before moving onto the next section to maintain alignment and lessen tolerance issues. Follow all the steps shown here on one section before moving onto the next section of drive rail.

### 2 Transfer the Drill Jig pattern onto the Drive Rail.

1. Position the drill jig at one end of the drive rail and align it 1-inch (25mm) from the edge.
2. Place the drill jig on the drive rail so the pins are against the outer edge of the drive rail.
3. The hole locations are centered in the grooved drive rail, 1.08 inches (27mm) from the outside edge.
4. Clamp the drill jig to the drive rail.
4. Use the center punch and a hammer to mark the hole locations.

### 3 Take the Drill Jig off the drive rail and drill through the marked holes.

1. Remove the drill jig.
2. Drill out the holes using a ¼-inch drill bit.
3. Place the countersink on the drill and countersink each hole. A well-aligned countersink is important to keep the screw heads flush with the drive rail.

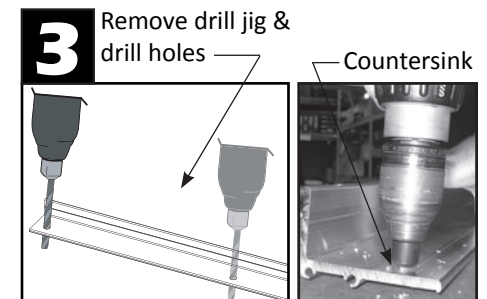
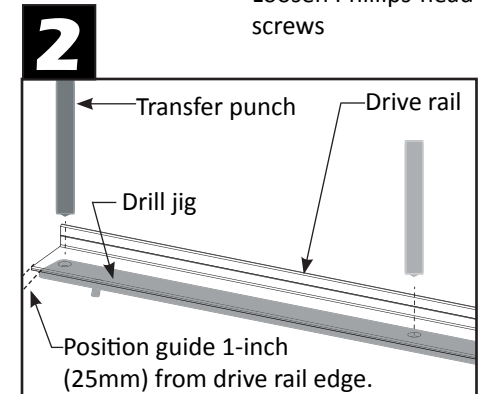
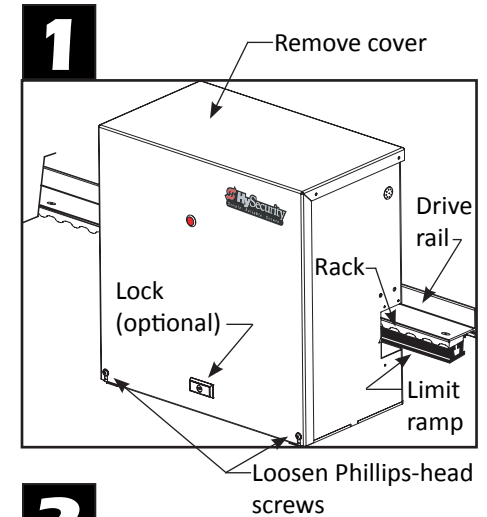

- Position the drill jig over the last hole and use a shoulder bolt to hold the jig in place while you mark the remaining section of the drive rail.



Alignment of the countersink is important because the head of the screw must be flush with the drive rail or the drive wheels can be damaged and void the limited warranty.

#### 4 Install the rack beneath the drive rail.

- Place the rack beneath the drive rail and make sure the holes align. Rack should be centered along the grooved rail. Check the hole alignments and make the necessary adjustments.
- Insert the rack nuts into the rack as shown. The nut provides the tapped screw hole for the flat head screws.
- Align the screw, rack, and rack nut with the countersunk hole. Add a drop of blue loctite to each screw prior to inserting it into the tapped nut. Finger tighten each screw to engage the nut.
- Continue along the entire drive rail section, fitting the rack together as you go.
- Use a Phillips-head screwdriver to tighten the screws and secure the rack to the drive rail.
- When you get to the end of the drive rail, you may need to cut the rack. Use a permanent marker to draw the cut line.
- Saw along the cut line with a hacksaw.

#### 5 Finish the installation of the XtremeDrive system. (Install the limit ramps and drive wheels. Readjust the limit switches, if necessary.)

- Mark and set the limit ramps.



Make sure to install all (standard and slow down) limit ramps if your SlideDriver is a 50VF series.

*continued...*

#### 3 Step 3 continued from page 1..., Reposition drill jig along the drive rail.

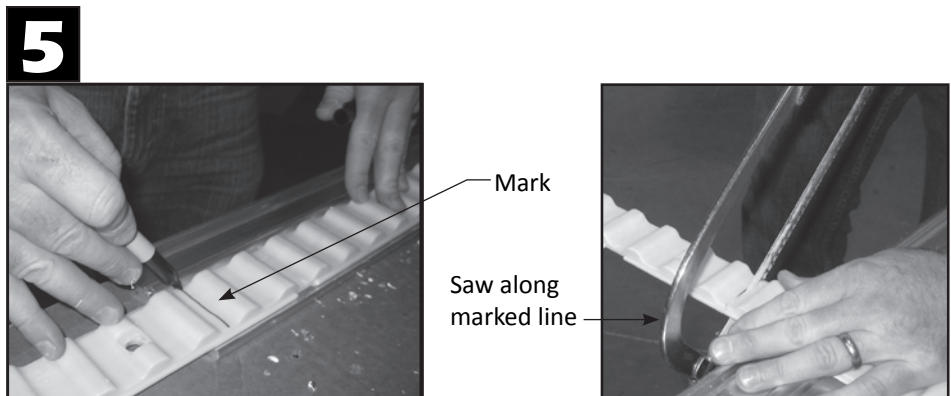
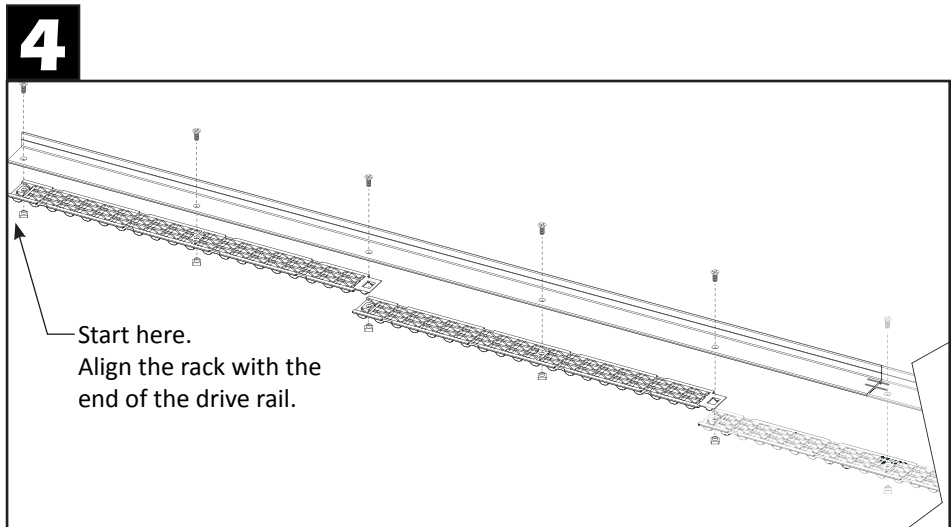
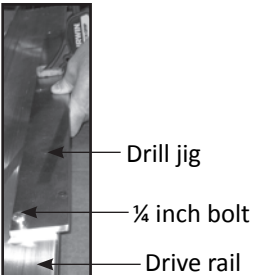
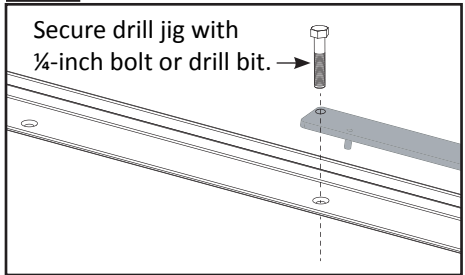

2. With the limits ramps installed, the rack should be sandwiched between the underside of the drive rail and the top of the limit ramp. Secure the limit ramps with the fasteners provided. (A minimum of two fasteners per limit ramp.)
3. Make the necessary height adjustments to the limits switches so they operate properly.
4. Recheck the height and alignment of the drive rail.
5. Replace the bottom drive wheel only. The XtremeDrive drive wheels are mounted the same way as the original drive wheels. If you are unfamiliar with installing drive wheels, read the instructions found in the [SlideDriver Installation Instructions](#).
6. To accommodate the increased drive wheel and drive rail height, you may need to replace the all thread rod. The rod is part of the drive wheel manual release. You need to remove its base nut using channel locks and replace the all thread with the 6.5 inch rod (16.5cm) provided in the drive wheel kit.
7. Cycle test the operator open/close to make sure XtremeDrive teeth are not being skipped.
8. Adjust the brakes, if necessary.



**Check the entire drive rail for alignment and make sure the XtremeDrive screws are flush with the surface of the drive rail. If the screw heads are not flush, damage can occur to the XtremeDrive drive wheels and void the limited warranty.**

## Maintenance

For Maintenance or troubleshooting issues, refer to the operator's product Manual. If you do not have a copy of the manual, it is available on the HySecurity website.

*continued...*

### 5 Step 5 continued from page 2... Drive rail, rack, and limit ramp.

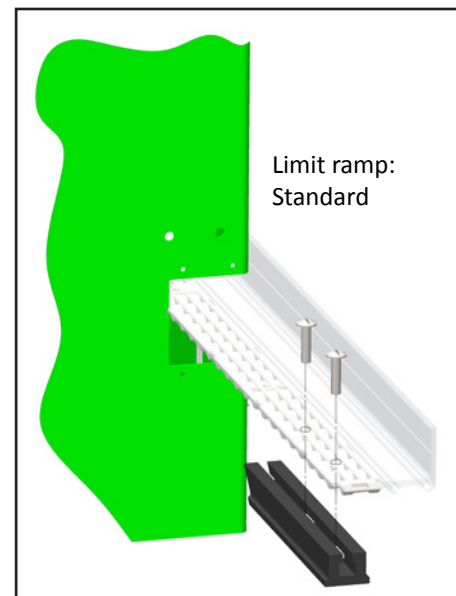
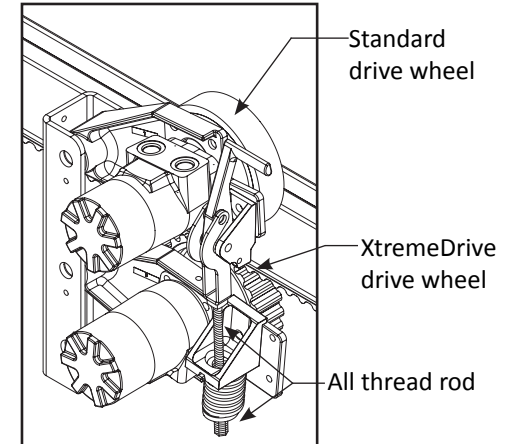
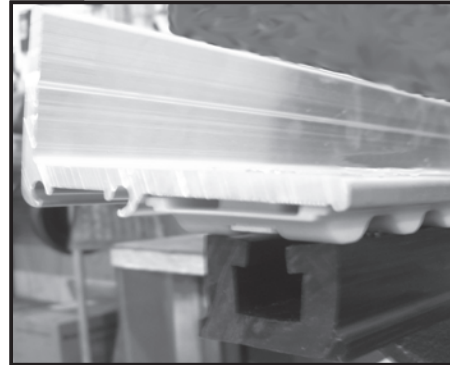

**SlideDriver 15, 30F, 40, 80, & 200**

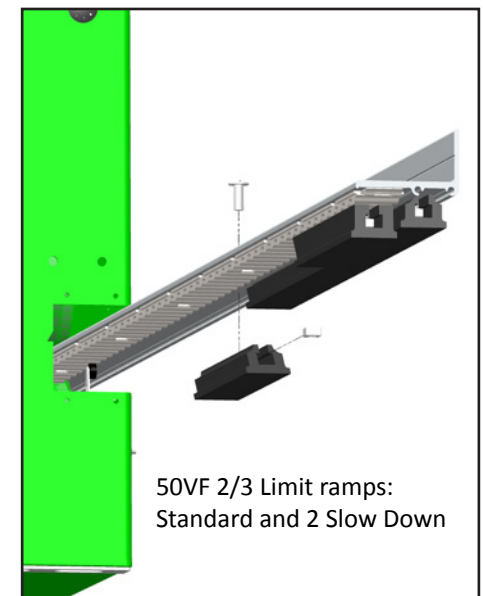

**SlideDriver 50VF series**

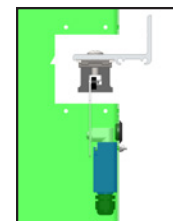

Reposition limit switches to accommodate for changes in drive rail height and thickness of the rack.

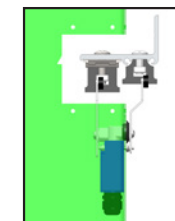

Reposition limit switches to accommodate for changes in drive rail height and thickness of the rack.



## Technical Support

For technical support, call your installer or authorized HySecurity distributor. Obtain the serial number of your operator before calling. For the name of a distributor near you, call HySecurity at 800-321-9947.

For information about HySecurity training for installers, maintenance personnel and end users, refer to the company website at [www.hysecurity.com](http://www.hysecurity.com) or call 800-321-9947.