

POWER HINGE™ INSTALLATION

A Weld Hinge to Post

Clamp the outside of the hinges to the post using a metal bar between the clamp and hinge as shown. Use the metal bar to ensure both hinges are equally aligned, level and positioned. When the hinges are properly positioned, weld them to the post making sure you **weld all four sides of each hinge**. Once you have a strong weld remove the clamps and metal bar used for alignment.

B Weld Hinge to Gate

Clamp the inside of the hinges to the gate using the metal alignment bar as shown. The gate must be in the open position for the clamps to fit. Make sure the gate and post is even and that the hinges are level and aligned. Weld inside hinge halves to gate making sure you weld all four sides of each hinge. Remove clamps and metal rod and gate is ready for use.

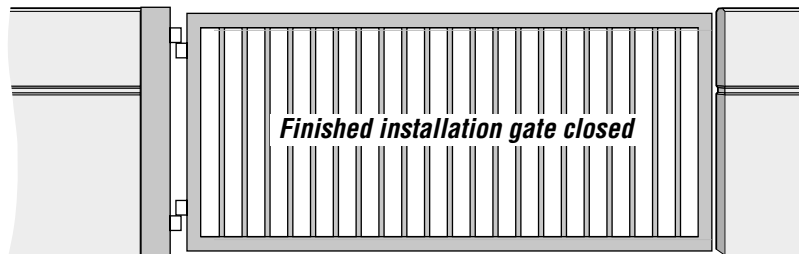
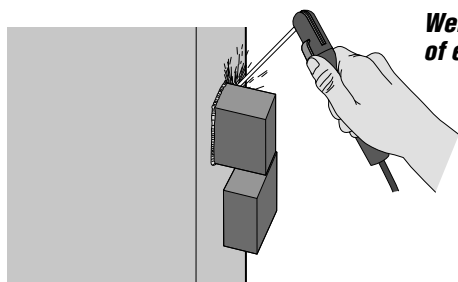
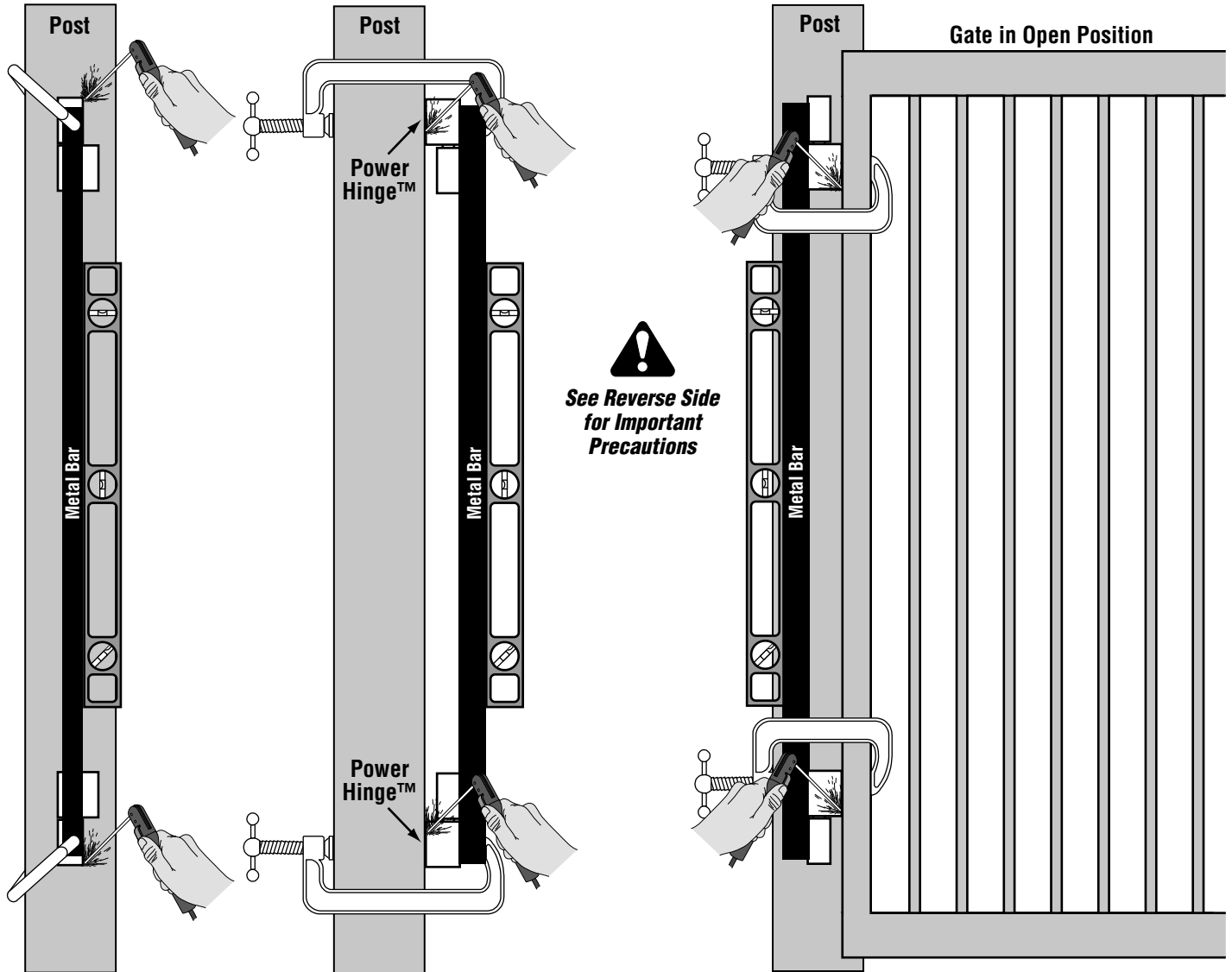

WARNING: This product can expose you to chemicals including lead, which are known to the State of California to cause cancer or birth defects or other reproductive harm. For more information go to www.P65Warnings.ca.gov

LiftMaster

Important Precautions

C Proper Alignment

It is **very** important, for smooth and proper operation of the gate, that the hinge shafts are in line and level.

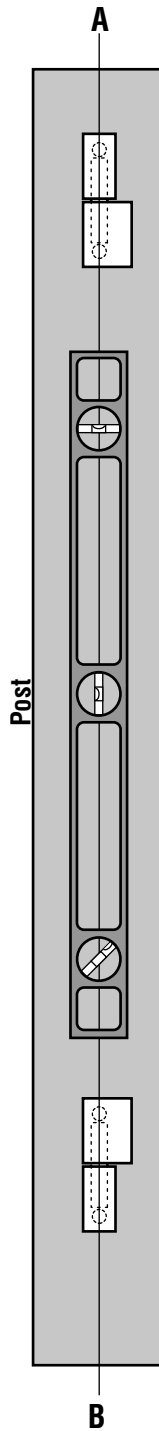

D Improper Alignment

Improper installation of the hinges will result in poor gate operation and shearing of the shafts.

